

FOR OFF ROAD/RACE USE ONLY!



Driven 2015-17 YAMAHA R-3 REAR SET RELOCATION BRACKET

Part#: DRR-001

INSTALLATION INSTRUCTIONS

Removal

1. Remove OEM rear sets (both sides) retain M8 bolts.
2. Remove shift rod, don't remove shift knuckle.
3. Remove master cylinder reservoir, retain M6 bolt.

TOOLS REQUIRED

- 10mm Open End Wrench
- 12mm Socket
- M6 Allen
- M4 Allen
- Blue Loctite
- Impact Gun

THE USE OF BLUE LOCTITE IS REQUIRED ON ALL MOUNTING HARDWARE!

Installation

1. Install DRP-100315(right side) and DRP-100316(left side).
2. Install OEM rear sets into the desired position.
3. Connect supplied shift rod and adjust to reach desired lever height.
4. Connect reservoir bracket (DRP-100317).
5. Connect oem reservoir to bracket using oem bolt (adjust so hose is not kinked).
6. Torque all bolts to oem specs and use blue Loctite for all hardware.

Make final adjustments as necessary and re-check all hardware after the first 300 miles of use.

THIS PRODUCT IS INTENDED TO BE INSTALLED BY A CERTIFIED TECHNICIAN*

FOR OFF ROAD/RACE USE ONLY!



**Driven Rearset Relocation Brackets for 2015-17 Yamaha R3
Part#: DRR-001**

Relocation Brackets
A00037

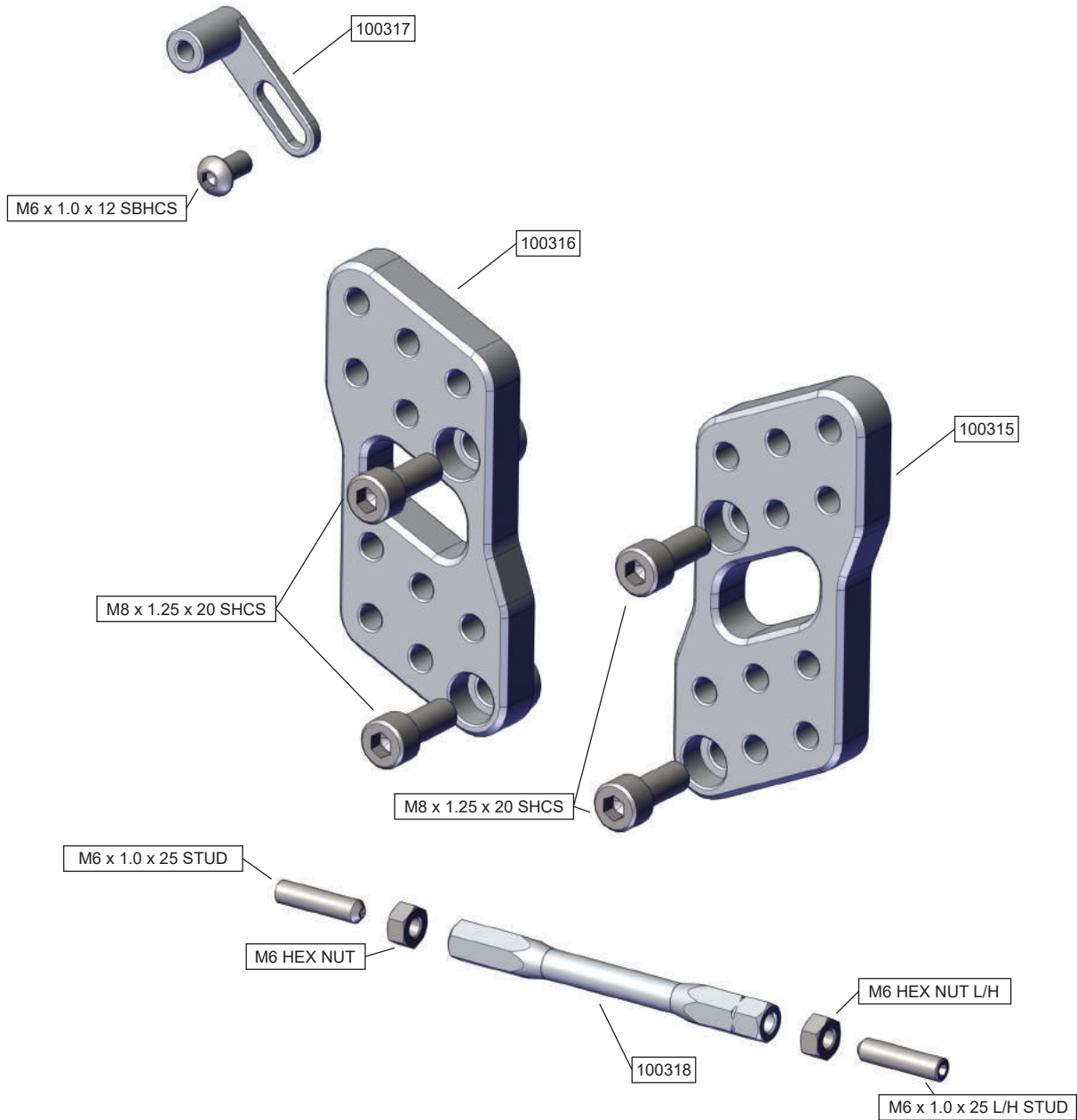

THIS PRODUCT IS INTENDED TO BE INSTALLED BY A CERTIFIED TECHNICIAN*