



FOR OFF ROAD USE ONLY

DRCAX-203 captive axle block  
17-19 Kawasaki Z 650/ EX 650

1. Lift rear wheel off the ground using a stand or a jack .
2. Remove rear axle while supporting rear wheel.
3. Remove stock blocks and axle flanges .
4. Install driven racing axle blocks onto axle flanges .
5. Install axle blocks into swing arm and tighten m6 bolts.(12 FT/LBS TORQUE) (NOTE :START AT THE MOST FORWARD POSITION)
6. Install axle and rear wheel and adjust chain.
7. Install safty nut(oem) onto axle flange . (12FT/LBS TORQUE)

Note: Due to design limitation you will loose about 1/4" of chain adjustment.

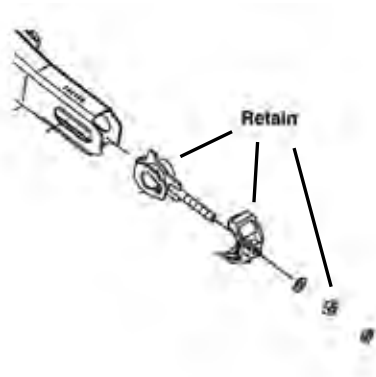

Note : use blue locktite on all screws. Use stock torque setting on axle nut .



FOR OFF ROAD USE ONLY

DRCAX-203 captive axle block  
17-19 Kawasaki Z 650/ EX 650

1. Lift rear wheel off the ground using a stand or a jack .
2. Remove rear axle while supporting rear wheel.
3. Remove stock blocks and axle flanges .
4. Install driven racing axle blocks onto axle flanges .
5. Install axle blocks into swing arm and tighten m6 bolts.(12 FT/LBS TORQUE) (NOTE :START AT THE MOST FORWARD POSITION)
6. Install axle and rear wheel and adjust chain.
7. Install safty nut(oem) onto axle flange . (12FT/LBS TORQUE)

Note: Due to design limitation you will loose about 1/4" of chain adjustment.

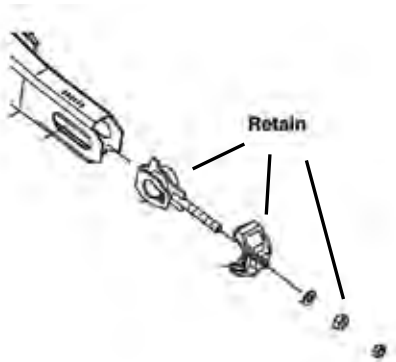

Note : use blue locktite on all screws. Use stock torque setting on axle nut .